

CMDV – Compact diaphragm valve

Compact diaphragm valve with male ends for solvent welding, metric series

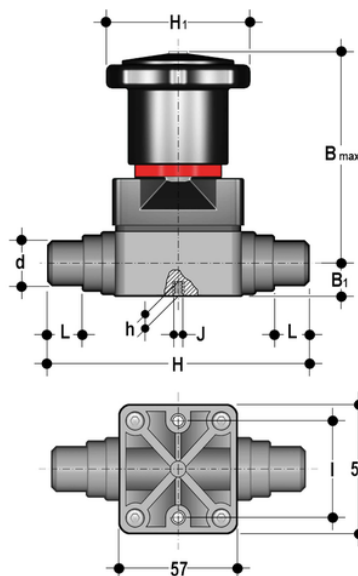

EPDM

| Objednáací číslo | d | DN | PN | product.detail.attribute.B max | B (5:1) | H | H (5:1) | product.detail.attribute.h | product.detail.attribute.l | product.detail.attribute.J | L |
|------------------|----|----|----|--------------------------------|---------|-----|---------|----------------------------|----------------------------|----------------------------|----|
| CMDV020E | 20 | 15 | 6 | 86 | 15 | 124 | 58,5 | 8 | 35 | M[5:5] | 17 |

FKM

| Objednáací číslo | d | DN | PN | product.detail.attribute.B max | B (5:1) | H | H (5:1) | product.detail.attribute.h | product.detail.attribute.l | product.detail.attribute.J | L |
|------------------|----|----|----|--------------------------------|---------|-----|---------|----------------------------|----------------------------|----------------------------|----|
| CMDV020F | 20 | 15 | 6 | 86 | 15 | 124 | 58,5 | 8 | 35 | M[5:5] | 17 |

PTFE

| Objednáací číslo | d | DN | PN | product.detail.attribute.B max | B (5:1) | H | H (5:1) | product.detail.attribute.h | product.detail.attribute.l | product.detail.attribute.J | L |
|------------------|----|----|----|--------------------------------|---------|-----|---------|----------------------------|----------------------------|----------------------------|----|
| CMDV020P | 20 | 15 | 6 | 86 | 15 | 124 | 58,5 | 8 | 35 | M[5:5] | 17 |

CMDV – Compact diaphragm valve

- **Handwheel in PA-GR, completely sealed**, high mechanical strength with ergonomic grip for optimum manageability
- **Integrated adjustable torque limiter** designed to prevent excessive compression of the diaphragm and always guarantee a minimum fluid flow
- **Optical position indicator** supplied as standard
- **Bonnet in PA-GR with STAINLESS steel nuts** fully protected by plastic plugs to eliminate zones where impurities may accumulate. Internal circular and symmetrical diaphragm sealing area
- **STAINLESS steel bolts**, can also be inserted from above
- **Threaded metal inserts** for anchoring the valve
- Connection system for solvent weld and threaded joints
- Extremely compact construction
- **Internal operating components in metal totally isolated from the conveyed fluid**
- Valve stem in STAINLESS steel
- **Compressor with floating diaphragm support**
- Easy to replace diaphragm seal
- Corrosion-proof internal components
- **CDSA (Circular Diaphragm Sealing Angle)** system offering the following advantages:
 - uniform distribution of shutter pressure on the diaphragm seal
 - reduction in the tightening torque of the crews fixing the actuator to the valve body
 - reduced mechanical stress on all valve components (actuator, body and diaphragm)
 - easy to clean valve interior
 - low risk of the accumulation of eposits, contamination or damage to the diaphragm due to crystallisation
 - operating torque reduction